

\$310,000 - 129, 36246 Range Road 251, Rural Red Deer County

MLS® #A2201847

\$310,000

0 Bedroom, 0.00 Bathroom,
Land on 1.54 Acres

Pine Lake West, Rural Red Deer County,
Alberta

Click brochure link for more details. Pine lake,
1.54 acres, Rosewood Estates. Lot 7 is ready
to build. Has Septic, water well and Hydro.

Gas available at Property line.

Well treed for privacy with sheds, pond in front,
paved to driveway, community docks for boats.

Fishing and Golfing in the area.

Essential Information

| | |
|-----------|------------------|
| MLS® # | A2201847 |
| Price | \$310,000 |
| Bathrooms | 0.00 |
| Acres | 1.54 |
| Type | Land |
| Sub-Type | Residential Land |
| Status | Active |

Community Information

| | |
|-------------|---------------------------|
| Address | 129, 36246 Range Road 251 |
| Subdivision | Pine Lake West |
| City | Rural Red Deer County |
| County | Red Deer County |
| Province | Alberta |
| Postal Code | T2J 3E5 |

Amenities

| | |
|------------|------|
| Waterfront | Pond |
|------------|------|



Exterior

Exterior Features None
Lot Description See Remarks

Additional Information

Date Listed March 14th, 2025
Days on Market 41
Zoning R-1

Listing Details

Listing Office Honestdoor Inc.

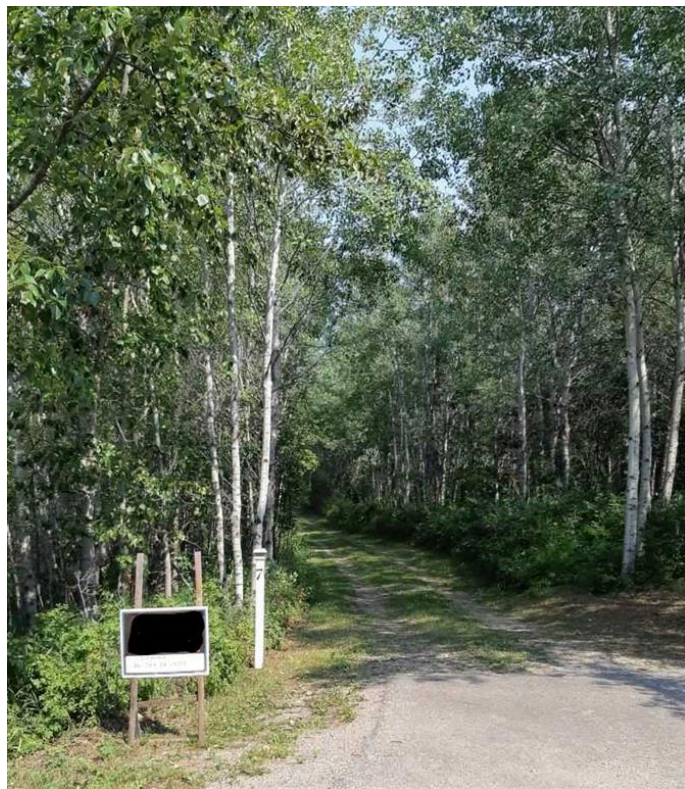

Data is supplied by Pillar 9â,,ç MLSÂ® System. Pillar 9â,,ç is the owner of the copyright in its MLSÂ® System. Data is deemed reliable but is not guaranteed accurate by Pillar 9â,,ç. The trademarks MLSÂ®, Multiple Listing ServiceÂ® and the associated logos are owned by The Canadian Real Estate Association (CREA) and identify the quality of services provided by real estate professionals who are members of CREA. Used under license.

