

\$3,188,888 - 240206 Vale View Road, Rural Rocky View County

MLS® #A2189899

\$3,188,888

0 Bedroom, 0.00 Bathroom,
Land on 160.00 Acres

NONE, Rural Rocky View County, Alberta

160 (+/-) acre parcel of land designated A-Gen, APPROXIMATELY 20 MINUTES TO CALGARY CITY LIMITS & 10 MINUTES TO CHESTERMERE CITY LIMITS AS WELL AS LANGDON CITY LIMITS! This parcel has a lot of potential with its location and size for future development. Directions: Travel east on Highway 1 (16 Ave) from Calgary, past Chestermere. Turn south on Highway 9, take the first right onto Township Rd 242, and follow west to Vale View Road (no sign on property). Contact your favorite realtor for a viewing today!

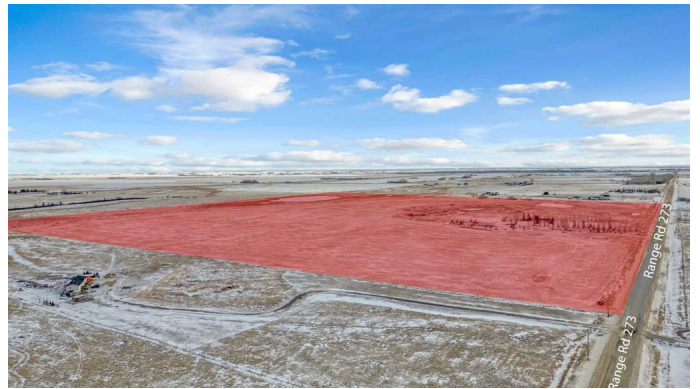
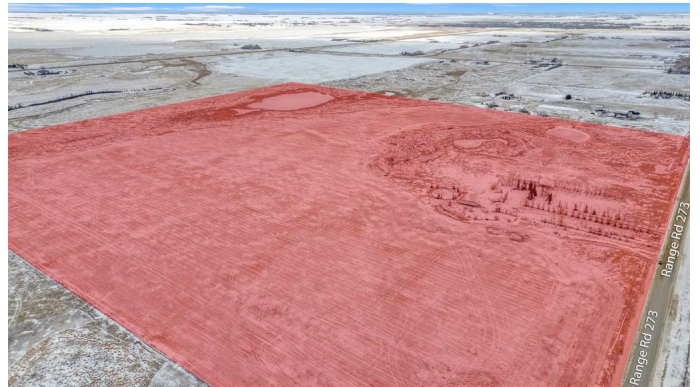

Essential Information

MLS® #	A2189899
Price	\$3,188,888
Bathrooms	0.00
Acres	160.00
Type	Land
Sub-Type	Commercial Land
Status	Active

Community Information

Address	240206 Vale View Road
Subdivision	NONE
City	Rural Rocky View County
County	Rocky View County

Province	Alberta
Postal Code	T1X 2G2

Additional Information

Date Listed	January 30th, 2025
Days on Market	82
Zoning	A-GEN

Listing Details

Listing Office	eXp Realty
----------------	------------

Data is supplied by Pillar 9â„¢ MLSÂ® System. Pillar 9â„¢ is the owner of the copyright in its MLSÂ® System. Data is deemed reliable but is not guaranteed accurate by Pillar 9â„¢. The trademarks MLSÂ®, Multiple Listing ServiceÂ® and the associated logos are owned by The Canadian Real Estate Association (CREA) and identify the quality of services provided by real estate professionals who are members of CREA. Used under license.