

\$450,000 - 191014 Township Road 685, Rural Athabasca County

MLS® #A2129454

\$450,000

0 Bedroom, 0.00 Bathroom,
Land on 155.34 Acres

NONE, Rural Athabasca County, Alberta

Here's a quarter section that offers a solution to just about any thing can suggest. Located east of the AIPac Mill in Athabasca County. It has some open land for income generation. It has some low treed land for recreation. It has a house that was moved onto a basement that was never finished. It had a camp and therefore services were in. It has a five acres graveled pad for a camp or laydown yard. It has pavement to the driveway so road bans never affect it. It will take the right person to need or utilize all that this quarter offers. Possibilities are endless.

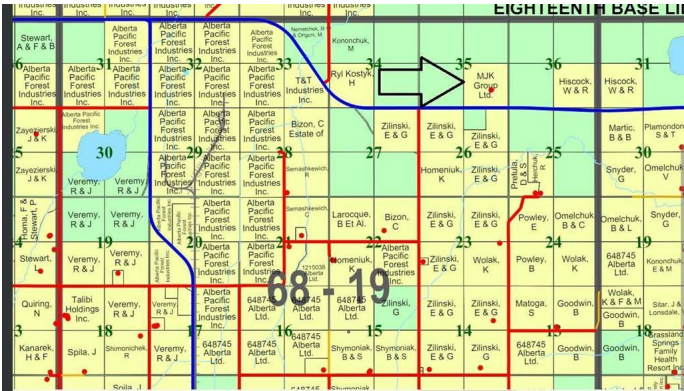

Essential Information

| | |
|-----------|------------------|
| MLS® # | A2129454 |
| Price | \$450,000 |
| Bathrooms | 0.00 |
| Acres | 155.34 |
| Type | Land |
| Sub-Type | Residential Land |
| Status | Active |

Community Information

| | |
|-------------|--------------------------|
| Address | 191014 Township Road 685 |
| Subdivision | NONE |
| City | Rural Athabasca County |
| County | Athabasca County |

| | |
|-------------|---------|
| Province | Alberta |
| Postal Code | T0A 1Z0 |

Additional Information

| | |
|----------------|---------------|
| Date Listed | May 6th, 2024 |
| Days on Market | 349 |
| Zoning | Ag |

Listing Details

| | |
|----------------|----------------------------|
| Listing Office | ROYAL LEPAGE COUNTY REALTY |
|----------------|----------------------------|

Data is supplied by Pillar 9â„¢ MLS® System. Pillar 9â„¢ is the owner of the copyright in its MLS® System. Data is deemed reliable but is not guaranteed accurate by Pillar 9â„¢. The trademarks MLS®, Multiple Listing Service® and the associated logos are owned by The Canadian Real Estate Association (CREA) and identify the quality of services provided by real estate professionals who are members of CREA. Used under license.